

STRAIGHT TORN FITTINGS

(THREADED O-RING, NIPPLE)

WorldWide Machining & Welding, Inc., is now manufacturing straight bodied TORN (Threaded O-Ring, Nipple) fittings.

FIELD APPLICATION

Straight TORN fittings can be used in a variety of applications, such as for purge and equalization during drain-up operations. TORN fittings are fully compatible with current hot tapping machines, thermometer wells, gauge adapters and other probe instrumentation devices.

FEATURES/SPECIFICATIONS

- Main body machined out of a solid piece of SA350 LF2 CL1 low temp material.
- Aluminum bronze plug.
- Viton o-ring.
- Teflon o-ring backer.
- Threaded pipe cap.
- Fitting main bodies and threaded caps stamped with size, rating/class, material grade and heat number.
- Fittings available in additional material types and grades upon request.
- Material test reports provided for all fittings supplied.

PROCUREMENT

Price and lead time quotes available upon request.

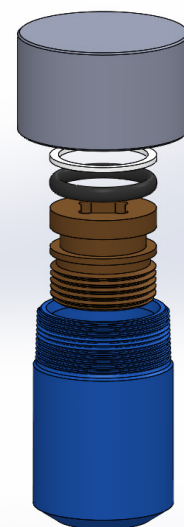

MODELS

2.0"	ANSI	600
3.0"	ANSI	600

Please reference the order drawings to designate fitting size, class rating and additional specifications.